



# the art of inspiration

## LOCATION

Set in Cincinnati, The Summit, a Dolce Hotel, offers cutting-edge spaces designed for exceptional meetings and events. Guests will enjoy contemporary, colorful guest rooms that offer relaxed accommodations for both business and leisure guests alike. Extensive indoor and outdoor meeting space, including over 20,000 ft<sup>2</sup> terrace and gardens, provide a blank canvas open to infinite possibilities to plan celebrations or unforgettable meetings.

## ROOM DETAILS

Perfecting your stay. The Summit offers sophisticated business amenities, including complimentary Wi-Fi access throughout the hotel, all delivered with Dolce's signature emphasis on the user experience. Guests can relax in one of 239 refreshing and expertly designed guest rooms and suites, featuring a California King Bed or two Queen Beds. Junior Suites, One Bedroom Suites and a Presidential Suite, most surrounding 9-story atrium, are available for guests who would like some extra room or to entertain visitors.

## DINING AND ENTERTAINMENT

**OVERLOOK KITCHEN + BAR:** Located on the fourth floor, Overlook Kitchen + Bar is a hip place to enjoy cocktails made with fresh, local ingredients. Complete your cravings with our irresistible dishes featuring local, seasonal produce and artisan meats.

**MARKET:** The market dining experience is like no other culinary experience in the city. All food is prepared to order by our chefs using the freshest ingredients with palate pleasing presentations. The urban contemporary dining room offers a beautiful open kitchen, comfortable seating, great views, and private dining rooms with full audio-visual amenities.

Both Overlook Kitchen + Bar and the Market open to the 3,800 ft<sup>2</sup> patio with commanding vistas northward.

## FIND YOUR NEXT INSPIRED MEETING

## AMENITIES

**FITNESS CENTER:** Stimulating fitness center choices include treadmills, elliptical machines, stationary bikes, weights, Peloton Bikes, and a 500 ft<sup>2</sup> yoga/studio space.

**LIBRARY:** A state-of-the-art library adds to the relaxing atmosphere. Take advantage of this casual space to relax, work or play a round of Billiards or Shuffleboard.

## MEETING SPACE HIGHLIGHTS

The art of inspiration. The Summit offers an inspirational environment to bring people together for unparalleled meetings and events. The hotel offers 21,000 ft<sup>2</sup> among 19 indoor flexible meeting and banquet rooms, located on multiple floors with convenient access. Chic indoor space, like The Madisonville Ballroom, complimented by 11,600 ft<sup>2</sup> rooftop terrace and gardens space, is perfect for large meetings or social events. Meeting facilities will exceed planner and attendee expectations with built-in audio-visual components and insightful design. Ergonomic chairs, Dolce's signature food and beverage program – **Thoughtful Food for Thoughtful Minds™**, and natural lighting inspire collaboration, creativity and the capacity to learn.

An evolution in coffee break snacks, **Nourishment Hubs™** up the ante on the Danish pastry by offering fresh and energizing refreshments throughout the day. Unique dining options provide meeting planners with convenient, flexible options to plan meals for their attendees as well as all-inclusive pricing for easy budget planning.



THE SUMMIT

A Dolce Hotel

5345 Medpace Way  
Cincinnati, OH 45227  
(513) 527-9900

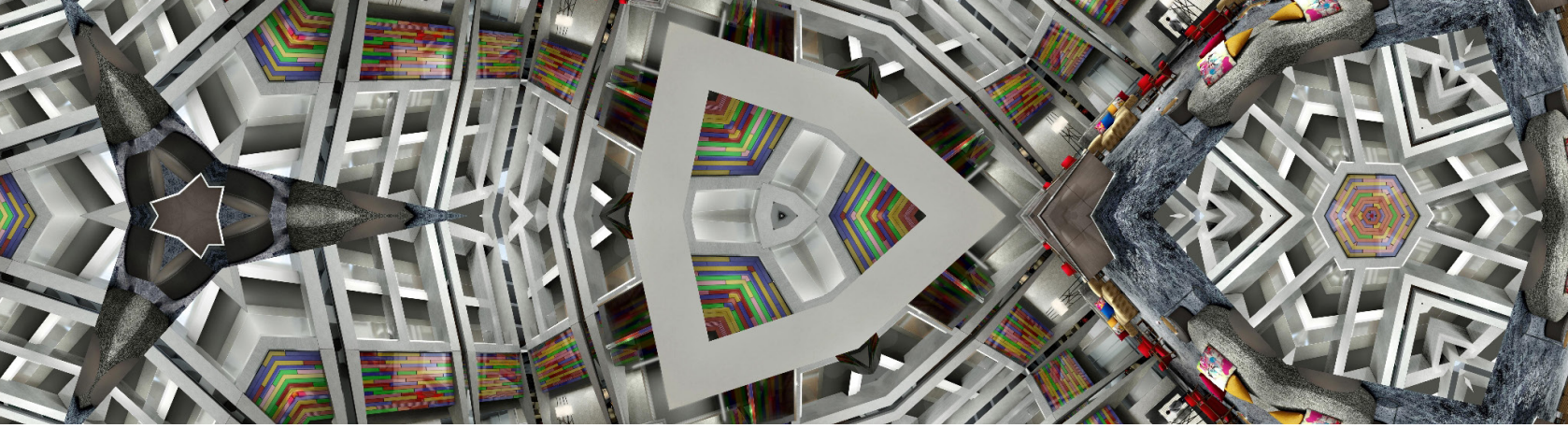

## MEETING SPACE CAPACITY CHART

NAME OF ROOM	SQUARE FEET	DIMENSIONS	CEILING HEIGHT	CLASSROOM 18" TABLES (3 PER 6 FT)	THEATER	BANQUET 60" RDS (10 PER RD)	CONFERENCE (3 PER 6 FT)
<b>1<sup>st</sup> FLOOR</b>							
Indian Hill	582	18' x 31.6'	13'10"	15	40	40	28
Western Hills	390	18.6' x 21'	12'10"	9	24	20	12
Walnut Hills	805	25.6' x 31.6'	13'10"	33	54	50	24
Library	210	14' x 15'	10'	N/A	N/A	N/A	N/A
Gallery / Exhibition	5,743	60' x 80'	±20'	250	250	380	N/A
<b>2<sup>nd</sup> FLOOR</b>							
Over-the-Rhine	659	18' x 30'	10'	36	44	30	28
The Banks	681	26' x 27'	10'	N/A	N/A	N/A	N/A
<b>4<sup>th</sup> FLOOR</b>							
Madisonville Ballroom A & B	4,750	57' x 82.6'	15'	270	320	320	82
Madisonville Ballroom A	2,358	57' x 41'	15'	100	160	160	40
Madisonville Ballroom B	2,392	57' x 41'	15'	100	160	160	40
Mt. Adams	1,350	27.6' x 48.6'	13'4"	54	90	80	46
Mt. Lookout	1,330	27.6' x 48.6'	13'4"	54	90	80	46
Mt. Washington	861	21' x 41'	10'8"	42	60	50	34
Mt. Washington A	425	21' x 21'	10'8"	18	30	20	16
Mt. Washington B	416	21' x 20'	10'8"	18	30	20	16
Mt. Auburn	861	21' x 41'	10'8"	42	60	50	34
Mt. Auburn A	425	21' x 21'	10'8"	18	30	20	16
Mt. Auburn B	416	21' x 20'	10'8"	18	30	20	16
Mt. Airy	572	18' x 32'	10'8"	30	38	40	28
Mt. Healthy	572	18' x 32'	10'8"	30	38	40	28
Market A	784	27.6' x 28.6'	13'	30	53	60	22
Market B	464	27.6' x 16.6'	13'	12	31	30	16
<b>4<sup>th</sup> FLOOR - OUTDOORS</b>							
Ault Park	8,000	N/A	N/A	N/A	215	160	N/A
Eden Park	3,600	N/A	N/A	N/A	50	40	N/A

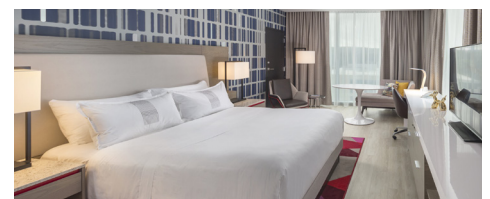

FIND YOUR NEXT INSPIRED MEETING

© 2018 Dolce Hotels and Resorts. All rights reserved.

  
**THE SUMMIT**  
 A Dolce Hotel